



jaga



CONTINUA

Dimensions & heat output



DIMENSIONS & OUTPUTS

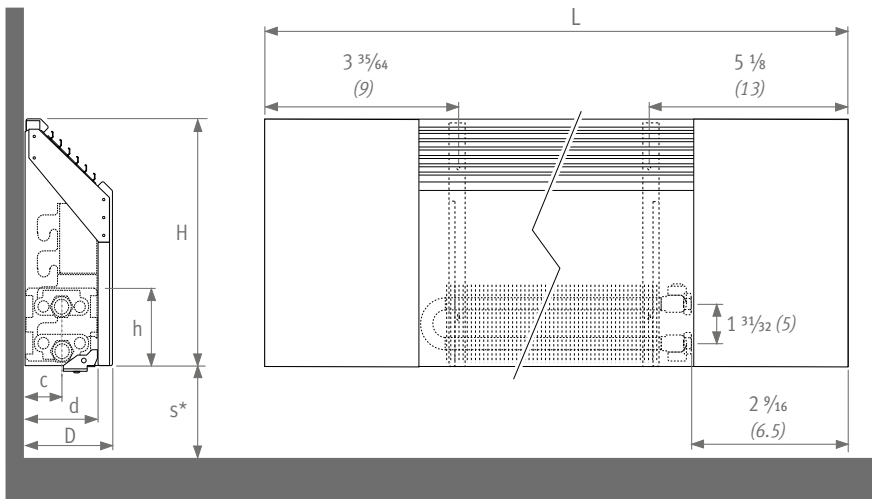

AVAILABLE LENGTH CABINETS

50 - 60 - 70 - 80 - 90 - 100 - 110 - 120
140 - 160 - 180 - 200

* Smaller dimensions can decrease output.

DIMENSIONS

Type	d	h	D	c	s
05	1 31/32 (5)	3 15/16 (10)	3 11/32 (8.5)	1 37/64 (4.0)	3 15/16 (10)
10	3 15/16 (10)	3 15/16 (10)	4 41/64 (11.8)	2 3/64 (5.2)	3 15/16 (10)
15	5 29/32 (15)	3 15/16 (10)	6 39/64 (16.8)	3 1/32 (7.7)	4 23/32 (12)
20	7 7/8 (20)	3 15/16 (10)	8 37/64 (21.8)	4 1/64 (10.2)	5 29/32 (15)

OUTPUTS

H 14 (35)	19.5 (50)	25.5 (65)
400	---	---
927	1080	1207
1525	1758	1943
2139	2463	2718

Average output in BTU/h foot active length with 65°F (18.3°C) entering air and 1 GPM flow rate. Mean water temperature of 160°F (71.1°C).

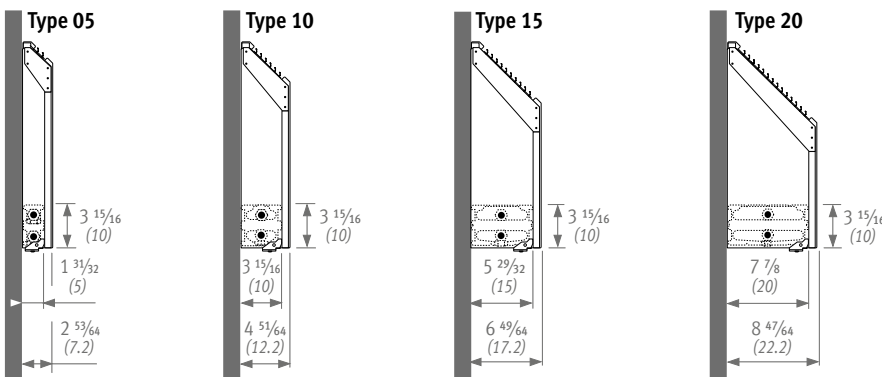

Height	Type	Pipe pass trough in brackets
14 (35)	05	✓
	10	✓
	15	✓
19.5 (50)	05	✓
	10	✓
	15	✓
	20	✓
25.5 (65)	05	✓
	10	✓
	15	✓
20	✓	

Note: dimensions in "() " are shown in centimeters.

The information in this technical brochure is correct at the time of printing. Jaga reserves the right to change product specification at any time in line with our policy of continuous improvement and innovation.

OPTIONS

A 30 mm perforation is foreseen in the brackets to allow pass trough of pipes in continuous installations.

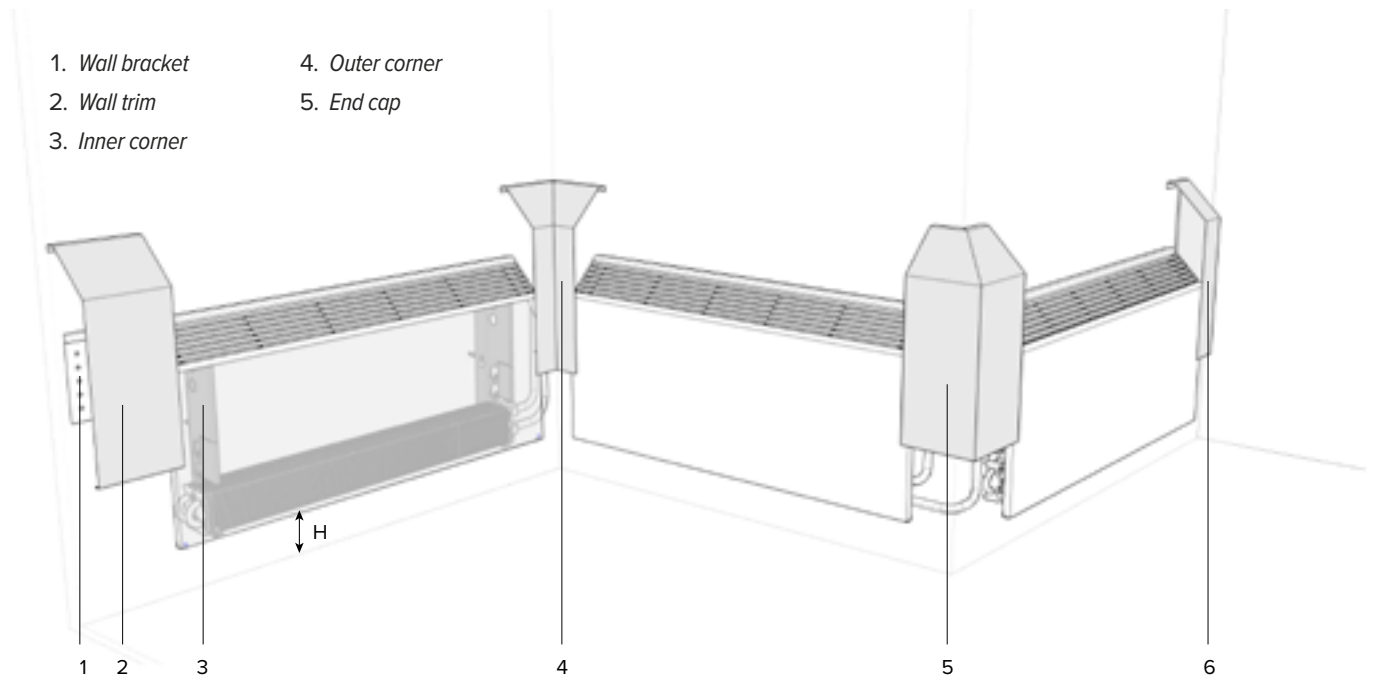

- 1. Wall bracket
- 2. Wall trim
- 3. Inner corner

- 4. Outer corner
- 5. End cap

INNER CORNER

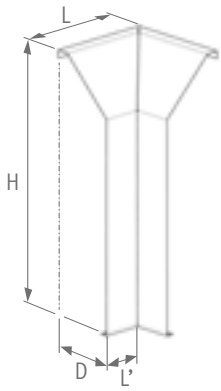

Height	Type	L
14 (35)	05 10 15	20 / 30
19.5 (50)	05 10 15 20	20 / 30
25.5 (65)	05 10 15 20	20 / 30 30

min. overlap: 1" (2.5)

WALL TRIM

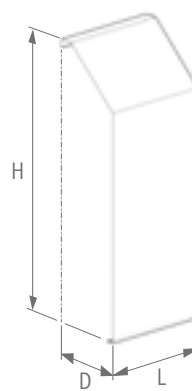

Height	Type	L
14 (35)	05 10 15	10 / 20 / 30
19.5 (50)	05 10 15 20	10 / 20 / 30
25.5 (65)	05 10 15 20	10 / 20 / 30

min. overlap: 1" (2.5)

OUTER CORNER

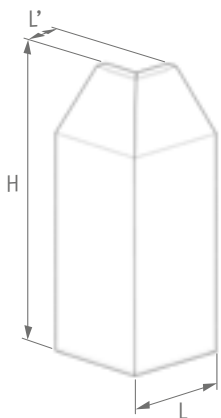

Height	Type	L
14 (35)	05 10 15	20 / 30
19.5 (50)	05 10 15 20	20 / 30
25.5 (65)	05 10 15 20	20 / 30 30

min. overlap: 1" (2.5)

END CAPS

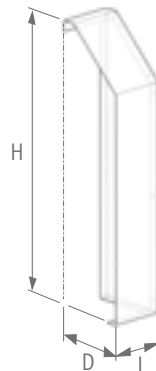

Height	Type	L
14 (35)	05 10 15	10 / 20 / 30
19.5 (50)	05 10 15 20	10 / 20 / 30
25.5 (65)	05 10 15 20	10 / 20 / 30

min. overlap: 1" (2.5)